

sentinel™ solar site lite Pad Foundation Installation (Surface Mount)

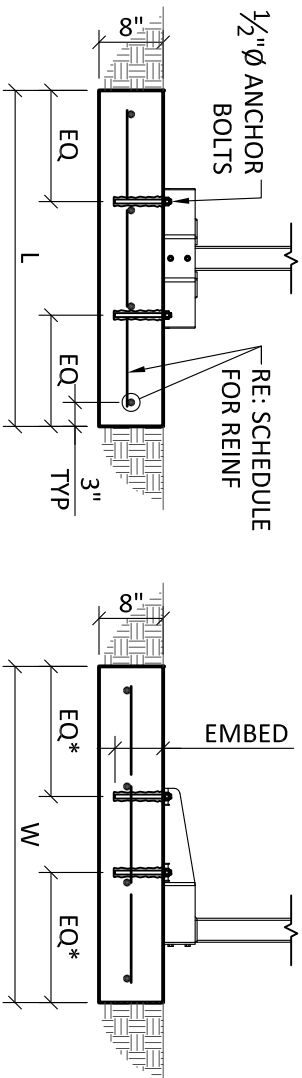

SECTION

SCALE: NONE

EQ - EQUAL
EW - EACH WAY
MIN - MINIMUM
CTR'D - CENTERED

PAD FOUNDATION			
IBC Basic	IBC Wind	LxW	Foundation Reinforcing
Wind Speed	Exposure Category		
90 mph	B or C D	3'-0" x 3'-0" 3'-6" x 3'-6"	(3) #4 EW CTR'D (4) #4 EW CTR'D
150 mph	B or C D	4'-0" x 4'-0" 4'-6" x 4'-6"	(4) #4 EW CTR'D

STRUCTURAL NOTES:

THIS DESIGN INTENDED FOR THE SUPPORT OF THE SOLAR LIGHT ASSEMBLY AS MANUFACTURED BY FLORENCE MANUFACTURING.

DESIGN IN ACCORDANCE WITH THE 2006 INTERNATIONAL BUILDING CODE (IBC). INSTALLER SHALL VERIFY LOCAL JURISDICTION FOR ADOPTIONS AND AMENDMENTS.

DESIGN WIND LOADS ARE BASED ON A BASIC WIND SPEED (3-SECOND GUST) OF 90 MPH & 150 MPH. RE: SCHEDULE FOR FOUNDATION REQUIREMENTS BASED ON VARYING WIND SPEED & EXPOSURE CLASSIFICATIONS. INSTALLER SHALL VERIFY DESIGN WIND REQUIREMENTS WITH LOCAL JURISDICTION.

FOUNDATION HAS BEEN DESIGNED FOR A MINIMUM NET ALLOWABLE SOIL BEARING PRESSURE OF 1,500 PSF.

FOUNDATIONS SHALL BEAR IN UNDISTURBED SOILS OR CONTROLLED STRUCTURAL FILL AS APPROVED BY A GEOTECHNICAL ENGINEER.

VERIFY FROST PROTECTION REQUIREMENTS WITH LOCAL JURISDICTION.

CONCRETE SHALL HAVE A MINIMUM COMPRESSIVE STRENGTH OF 4,000 PSI AT 28 DAYS UNLESS OTHERWISE SPECIFIED.

THE WATER/CEMENT RATIO SHALL NOT EXCEED .50 FOR ALL CONCRETE.

REINFORCING STEEL SHALL BE BILLET STEEL CONFORMING TO ASTM A615, GRADE 60.

ALL CONCRETE SHALL BE AIR ENTRAINED, 6%(±) BY VOLUME.

ANCHOR BOLTS SHALL BE HILTI HIT-TZ/HY 150 MAX ADHESIVE, HDA UNDERCUT, OR HSL OR HSL-3 HEAVY DUTY SLEEVE ANCHORS (OR APPROVED EQUIVALENT) AND SHALL BE INSTALLED PER MANUFACTURER'S RECOMMENDATIONS.

CERTUS 
GROUP

117 SW 6th Avenue; Suite 201
Topeka, Kansas 66603
Phone: (785)291-0400

sentinel™
**PAD FOUNDATION INSTALLATION
(SURFACE MOUNT)**

FLORENCE MANUFACTURING

DESIGNED BY
AMS

DRAWN BY
AMS

APPROVED BY
TRT

DATE
11/08/07

SHEET NO.

W.O. **01070065**

S1.1